

OELO LIGHTING INSTALLATION MANUAL



STEP 1

Note: We recommend consulting Oelo on Booster Box strategies for any light systems with more than 300 lights and non-linear structures.



WARNING

Do NOT leave copper wiring exposed.



WARNING:

Do NOT plug in the system until ALL wiring is complete. Wiring while the system is live will void Oelo's 5-year warranty.

Adding a Booster Box

The Control Unit can only power 300 lights. If the system is linear (ran in a straight line), you can add a Booster Box after Light #300. This Booster Box can also be added anywhere in the run to help offset non-linear systems. To add:

- A. Hang the box near a nearby power source (a standard 110V outlet).
- B. Insert the 3-Core Cable into the Large Strain Relief.
- C. Connect the 3-Core Cable wires, inserting the:
 - i. +VCC WIRE into the RED CONDUCTOR; close conductor port.
 - ii. GND WIRE into the BLACK CONDUCTOR; close conductor port.
 - iii. The S (Signal) WIRE will not be used inside the box.
- D. Run the 3-Core Cable up to Light #301 and strip, feed, crimp and shrink:
 - i. The Booster Box Cable's GND wire AND Light Strand 300's GND wire TOGETHER in a BLUE Butt Connector; insert the next Light Strand's GND into the other side of the Butt Connector.
 - ii. Insert the Booster Box Cable's +VCC wire in a PINK Butt Connector; insert the next Light Strand's GND into the other side of the Butt Connector.
 - iii. Insert Light Strand 300's S wire into a PINK Butt Connector with the new Light Strand's S wire.
 - iv. Use Butt Connectors to cap off and waterproof the Booster Box's S wire, and the Light Strand 300's +VCC wire; these wires will not be used.
- E. Continue wiring your system, connecting and jumping light strings as needed.

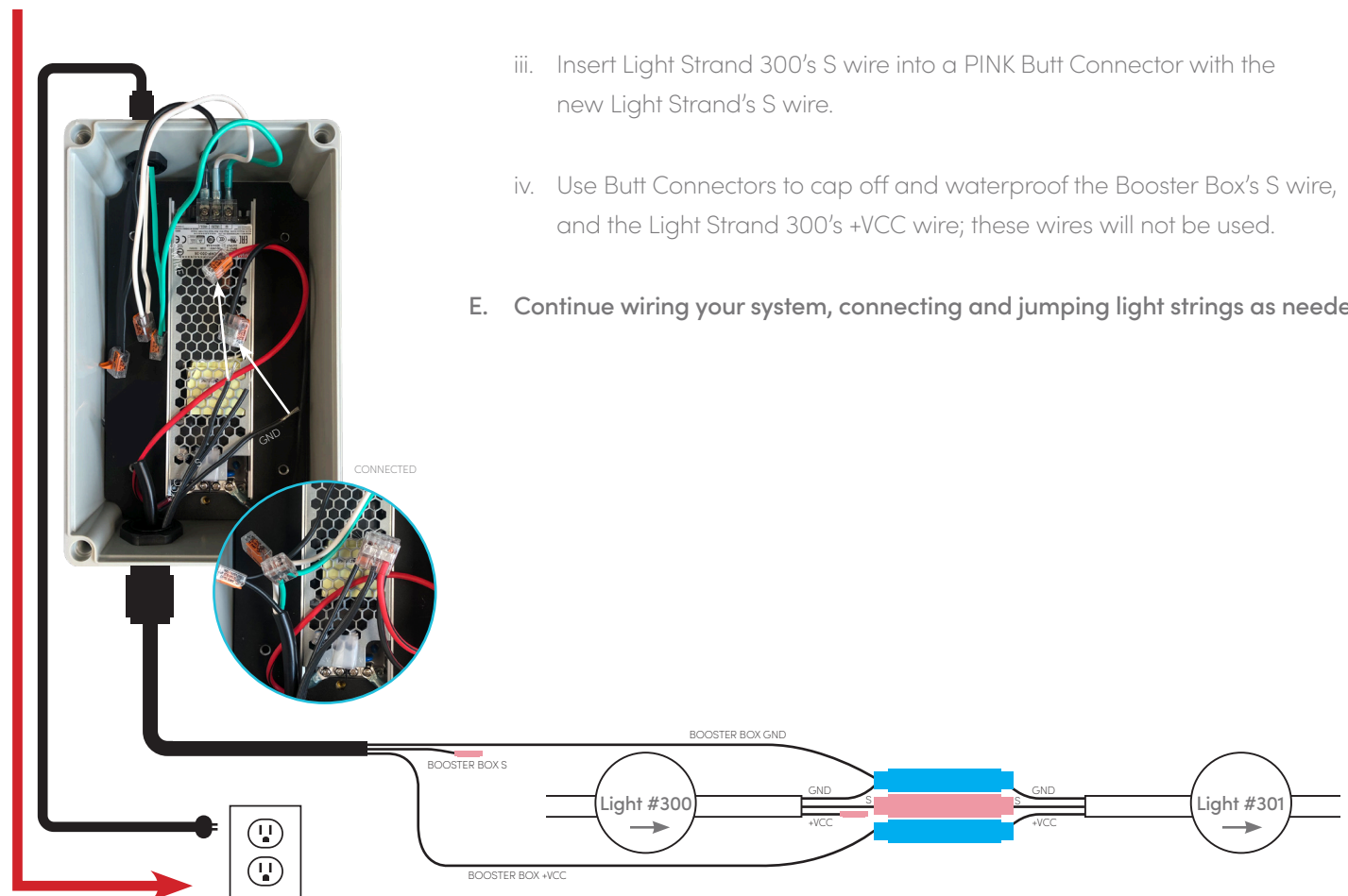

STEP 2

The finishing touches

- A. **Plug in the Control Unit and additional Booster Boxes and test the system.**
(Follow the instructions on Control Panel Door to test or troubleshoot the lights.
For instructions on how to operate the Oelo app, please see the Oelo app instructions.)
- B. **Admire your stunning work!**



Tag us in your photos and videos please!



@oelolightingsolutions



@oelolighting



@oelolighting



@oelo



oelo.com | 3842 Redman Dr., Fort Collins, CO | 970.212.3670

See an Oelo representative or authorized installer for further details. All information in this brochure is the latest available at the time of publication. Printed in the USA. 0521 ©2021 Oelo